

Trimmer Troubleshooting Guide

My trimmer won't start, what do I do?

Below are a few steps I would like you to try on your trimmer, you will be needing a Philips head screw driver, a ruler and a paper clips for a few of these steps.

1. Check the oil level and make sure it is at the appropriate level. There should be no more than 1.7oz of standard 10W30 inside your unit at anytime. Looking at the dipstick, the oil level should be right at the top of the circle which can be found around the middle of the dipstick.

2. Take off the air filter cover with the Philips screwdriver. Once it is off, make sure the air filter is not wet, if wet try to get it as dry as possible (wring with paper towel) before putting it back on. Also check for any damage on the air filter plate which is the black piece the air filter is attached to.

3. Next wiggle the carburetor to make sure it is secure to the manifold. If it is loose then your manifold is likely cracked and it will need to be replaced. If secure please proceed to the next step.

4. Take a look at "How to prime the carburetor" in our Diagrams and Downloads section and follow the instructions. This is where the paper clip will come in handy; also keep in mind that you may need to repeat this step two or three times for it to work properly. If still having trouble refer to the next step.

5. Open "Trimmer Needle Adjustment" also found in our Diagrams and Downloads sections and follow the steps accordingly, this is where the ruler will come in handy.

If you are still having trouble please give us a call and we will be happy to assist you. We apologize for the inconvenience and thank you for your continued patience.

Why is my shaft vibrating?

The best way to find out if you are in need of a replacement part is to detach the lower half of your trimmer and run it to see if the vibration persist. If it does you will need additional troubleshooting in which case you can call LEHR Customer Service or open up a ticket online.

What attachments will fit this trimmer?

We offer a brush cutter blade attachment, which will only fit on the Straight Shaft Eco Trimmer. In addition to that, we are compatible with Ryobi, Troy built and Craftsman attachments which work on all of our Detachable Eco Trimmers (ST025DS & DC).

How do I get this trimmer head off?

ST025DC- Simply turn the bottom bump feed to the left to unscrew it.

ST025DS-Line up the hole in the drive disk and gear head, stick an Allen Wrench (Included in Accessory bag) or screwdriver in to stop the head from spinning and twist the trimmer head to the left.

If you are having trouble with this or the head is not turning, please contact LEHR Support.

1.F - HOW TO PRIME THE PROPANE CARBURETOR

1. Remove the air filter cover with a phillips head screw driver.
2. Locate the diaphragm vent hole on the side of the carburetor facing the front of the trimmer.
3. With the propane tank attached, use a paper clip or similar diameter rod to lightly depress the diaphragm by inserting it into the diaphragm vent hole.
4. Depress for 2-3 seconds then pull out.
5. Reinstall the air filter cover and start the engine.
6. If these procedures do not work, tap the carburetor a couple times with a wrench.

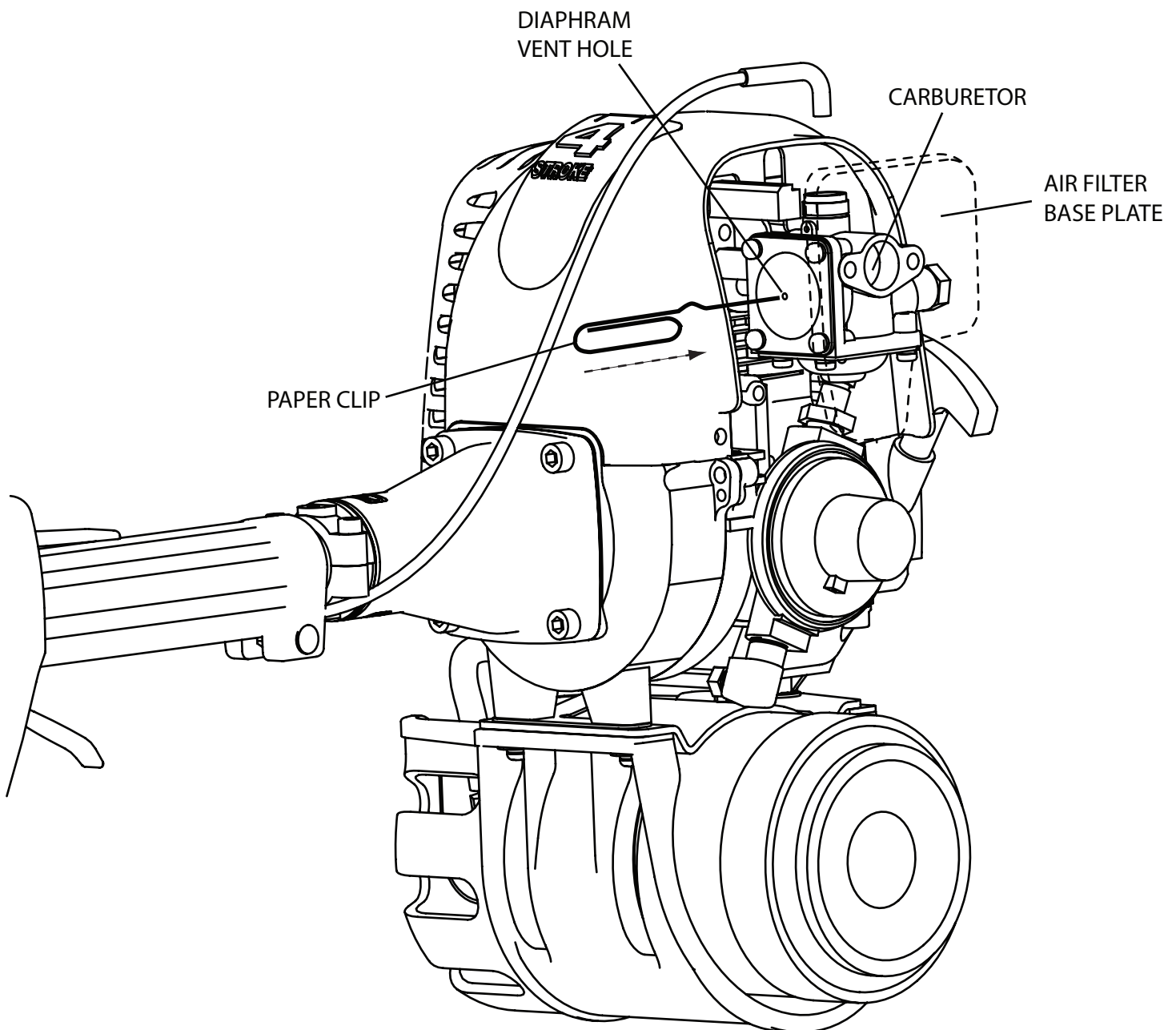

1. Remove the air filter cover with a phillips head screw driver.
2. Remove the cap from the top of the carburetor. It can be loosened with a 3/4" or 19 mm open end wrench. Unscrew the cap and pull it out along with slide and needle.

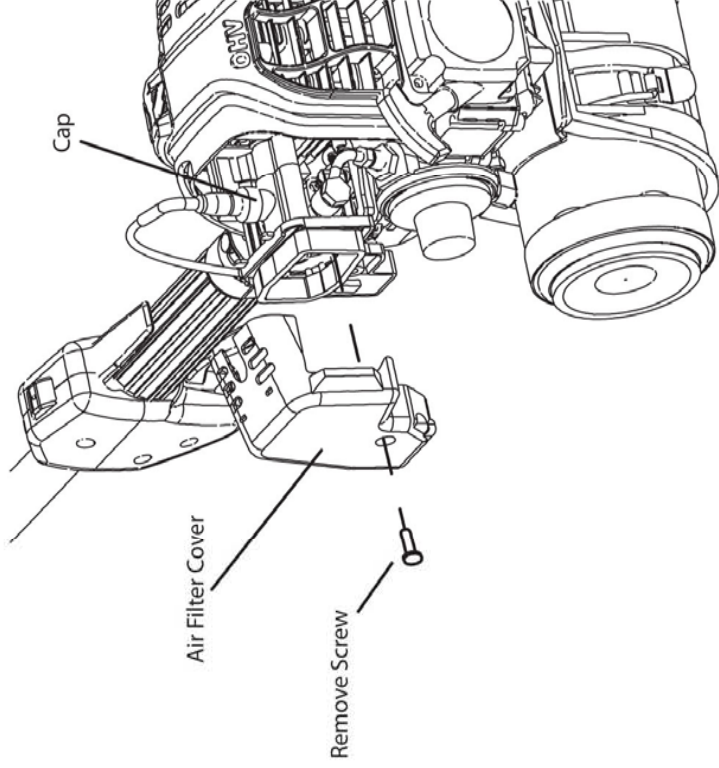

3. Grip the black carburetor slide with your fingers and grip the brass needle firmly but carefully. Turn the needle clockwise, or up into the Slide, one half turn. Once done, reassemble the carburetor and air filter cover. Then, restart the engine and check for improvement.

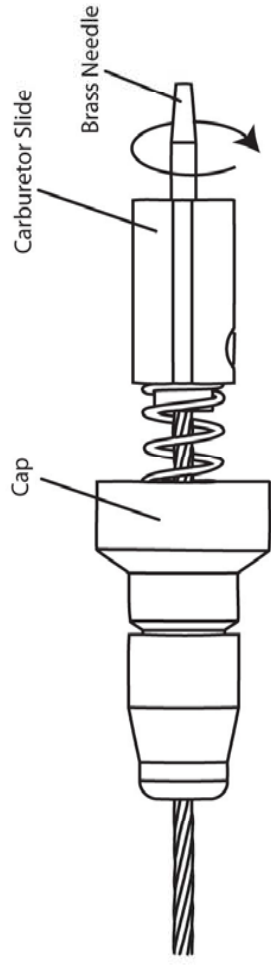

4. If the condition is improved, but not yet completely fixed, repeat the adjustment as necessary, but do not turn the needle more than 1-1/2 turns total. Replace the carburetor if 1-1/2 turns does not fix the problem.
5. It is normal after making the adjustment, that the idle speed will be slower than the speed before adjustment. To correct, adjust the idle faster by turning the idle speed adjustment screw clockwise.

